

19 Wharf Road WEST RYDE NSW

3 2 3

METICULOUSLY RENOVATED FAMILY HOME

Sublime residence in riverside locale!

Promising a lavish life full of entertaining, this brilliantly designed residence offers an effortless family lifestyle with superb comfort.

Occupying an 607sqm level parcel in an exclusive riverside suburb, this impeccable home is walking distance to transport infrastructure, with direct access to Parramatta and Sydney CBDs. With location being one of it's biggest assets, it is also minutes from the popular Melrose Park Primary School, Meadowbank park, shops and river front.

High Points

Price : \$ 1,338,000
Land Size : 607 sqm
View : <https://www.mypropertyepping.com.au/sale/nsw/northern-suburbs/west-ryde/residential/house/5674976>



Peter Horozakis
(02) 9868 4888

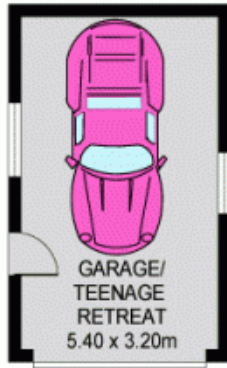

GROUND FLOOR

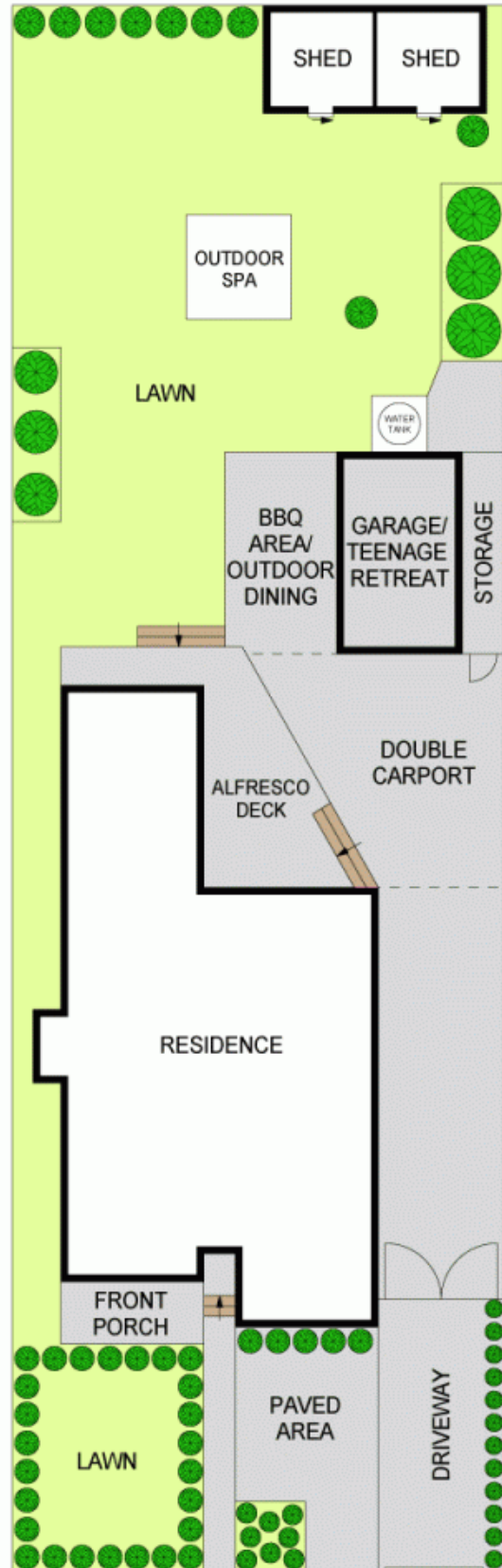

SITE PLAN
(NOT TO SCALE)

19 WHARF RD, MELROSE PARK

Disclaimer: Please note that while the information contained in this floor plan is provided by reliable sources, we cannot guarantee its accuracy. It is intended as a guide only. Interested parties should rely on their own enquiry. Drawing not to scale. Dimensions are approximate.

