

1/51-53 Cross Street Guildford NSW

3 2 2

Villa style apartment - New paint, carpet & double garage.

Be inspired by this unique and renovated designer apartment that feels just like a villa home. Total area of 156m².

Presenting an opportunity like no other, this architect design young apartment boasts expansive modern spaces flooded with fresh interiors, natural light and most of all convenience.

Positioned in one of Guildford's most popular locations, it is walking distance to Guildford shops, train station, popular schools, parkland and only a short drive to Woodville Road, M4 motorway, Merrylands and Parramatta CBD. Apartments of this calibre are almost impossible to find and incredibly rare in the area. Everything you need just around

Price : \$ 520,000
Building Size : 156 sqm
View : <https://www.mypropertyepping.com.au/sale/nsw/parramatta/guildford/residential/unit/5675026>



Peter Horozakis
(02) 9868 4888

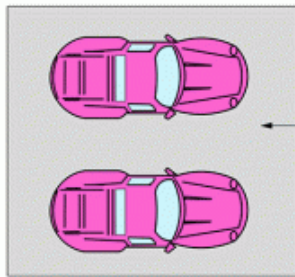

SECURITY
DOUBLE
GARAGE
5.60 x 6.80m

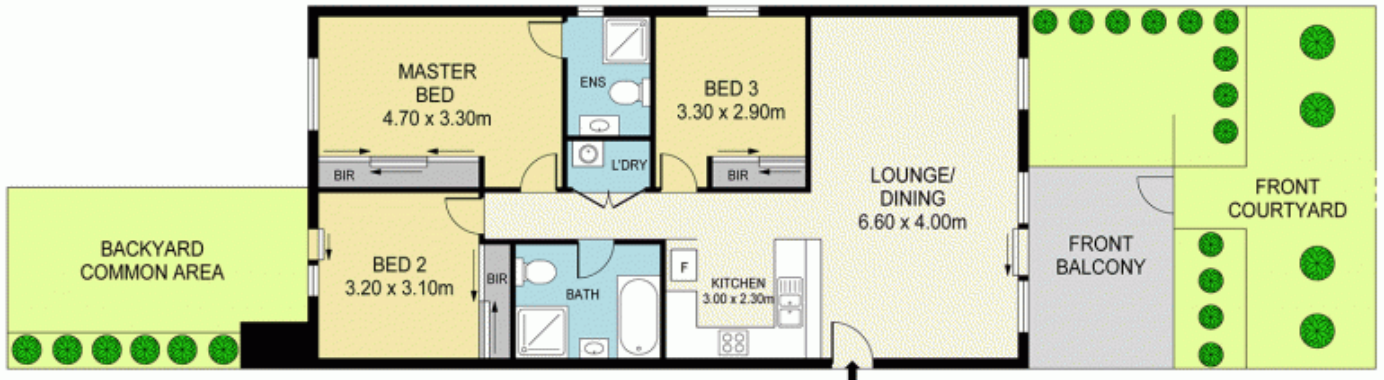

1/51-53 CROSS ST, GUILDFORD

Disclaimer: Please note that while the information contained in this floor plan is provided by reliable sources, we cannot guarantee its accuracy. It is intended as a guide only. Interested parties should rely on their own enquiry. Drawing not to scale. Dimensions are approximate.

MY PROPERTY OFFERS