



Lot 1/49 Atkins Road Ermington NSW

4  2  2 

Brand New & Grand Architectural Home.

Indoor-Outdoor Entertaining in one Free-flowing package.

IT'S RARE to find a Duplex that embodies virtually all the elements of a custom-created House, but surely this is it? Architect-designed by one of the country's best, this Duplex incorporates generous family accommodation, spacious open-plan living areas, multiple outdoor spaces, privacy and security in a stunning contemporary design with quality finishes.

Externally, the modern design straddling a corner block, commands immediate attention with its sharp black-on-white architecture, fully-rendered surfaces, and clean, striking finishes. The expansive dual-level design incorporates large glass surfaces that spill natural light into

**Land Size** : 313 sqm  
**View** : <https://www.mypropertyepping.com.au/sale/nsw/parramatta/ermington/residential/house/7819106>



**Peter Horozakis**  
(02) 9868 4888



**Rob Luck**  
(02) 9868 4888



COVERED ALFRESCO



GROUND FLOOR

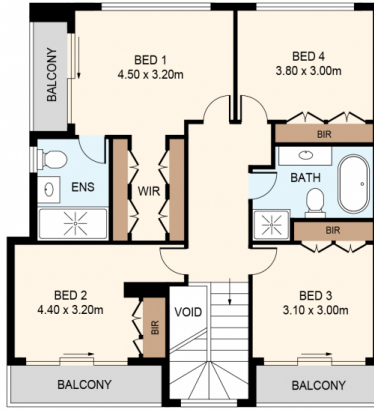

FIRST FLOOR



SITE PLAN  
(NOT TO SCALE)



DISCLAIMER: THIS IS FOR ILLUSTRATIVE PURPOSES ONLY.  
ALL DIMENSIONS ARE APPROXIMATE AND IT DOES NOT  
CONSTITUTE PART OF ANY LEGAL DOCUMENTS.

ADDRESS:

LOT1/49 ATKINS RD, ERMINGTON