

2153 Pittwater Road Church Point NSW

4 🛏 3 🚿 6 🚗

Prestigious Pittwater Delight!

A statement in quality, design, and pure elegance, with a seamless contemporary style, this is truly a spectacular waterfront residence in a class of its own. Designed to meet the high standards of modern family living with attention to detail, this most amazing lifestyle opportunity that is rarely offered on the rental market. Perfectly positioned and set back from Pittwater Rd, this impeccably appointed family home showcases high quality modern fixtures and fittings & impressive water views amongst this tranquil Church Point setting.

Simply breathtaking in every way with jaw dropping sunrises, this Robert Jones architecture provides the very best in entertaining with its perfect North-East aspect. Ultra-convenient, it's Blue Ribbon locale just seals the deal

View : <https://www.mypropertyepping.com.au/lease/nsw/northern-beaches/church-point/residential/house/7872807>



Peter Horozakis
(02) 9868 4888



George Horozakis
(02) 9868 4888



FIRST FLOOR



GROUND FLOOR

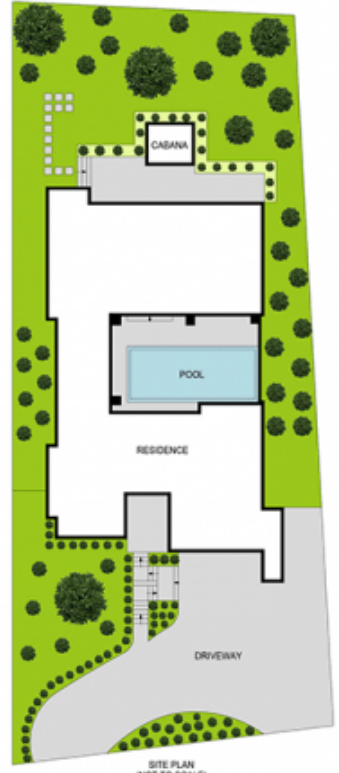

(SITE PLAN (NOT TO SCALE))

DISCLAIMER: THIS IS FOR ILLUSTRATIVE PURPOSES ONLY. ALL DIMENSIONS ARE APPROXIMATE AND IT DOES NOT CONSTITUTE PART OF ANY LEGAL DOCUMENTS.

ADDRESS:

2153 PITTWATER ROAD, CHURCH POINT